

VDRG[®] PEDV Ag Rapid Kit

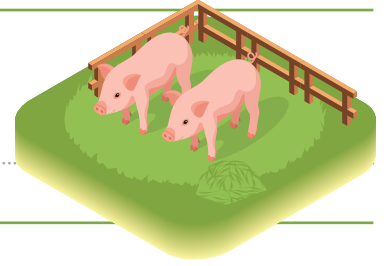

Porcine Epidemic Diarrhea Virus

Porcine Epidemic Diarrhea Virus (PEDV) is an RNA virus belonging to corona virus. If acutely infected with PEDV, it is characterized by inducing vomiting and watery diarrhea regardless of the age of swine. Although the death rate is low as 1-3% range by recovering within one week after infection in case of grown swine, the death rate is 50% in case of piglets and may be 100% in severe cases. This test kit, the diagnostic reagent can detect PEDV antigens quickly and simply within 10 minutes after dropping the samples.

Introduction

- + **Intended use** : Detection of Porcine Epidemic Diarrhea Virus antigen
- + **Principle** : Immunochromatographic assay
- + **Specimen** : Porcine diarrhea feces
- + **Component**
 - PEDV Ag Rapid device
 - Sample dilution buffer
 - Swabs
 - Dropper



Features

- + Easy test, Ready-to-use reagent
- + High correlation with RT-PCR and a high reproducibility and accuracy.
- + Clinical sensitivity : 98.3% (228/232) vs RT-PCR
- + Clinical specificity : 98.6% (276/280) vs RT-PCR
- + No cross-reaction with other viruses

Test procedure

- 1 Collect a diarrhea specimen from diarrhea feces or those in the anus using swabs for fecal specimen collection.
- 2 Put the specimen into the container that contains sample dilution buffer and stir well the solution with a swab in order to extract the virus from the fecal specimen thoroughly.

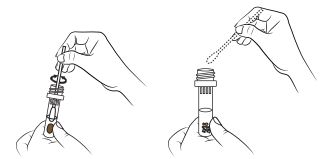
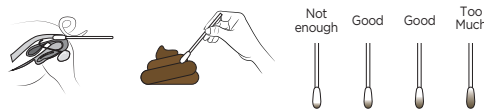

- 3 Place the tube upright until the large particles go down.(20sec.)
- 4 Take the supernatant of specimen solution using dropper, and then instill 4 drops into the test device.
- 5 Read test results after 10 minutes.

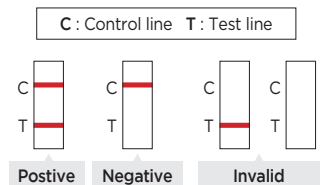
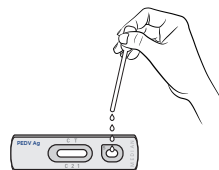
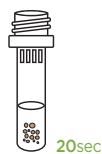

Order Information

Cat No.	Product Name	Quantity
PS-PED-11	VDRG [®] PEDV Ag Rapid Kit	10 Tests/Box, 40 Tests/Box